

KF510 Series

Paddlewheel Flowmeters

4. JA wafer type

DN (mm)	C	N-ØA	Pressure (MPa)	Medium temp. (°C)
32	100	4-Ø18	≤0.8	≤80°C
40	110	4-Ø18		
50	125	8-Ø18		
65	145	8-Ø18		
80	160	8-Ø18		
100	180	8-Ø18		
125	210	8-Ø18		
150	240	8-Ø22		
200	295	8-Ø22		
250	350	12-Ø22		

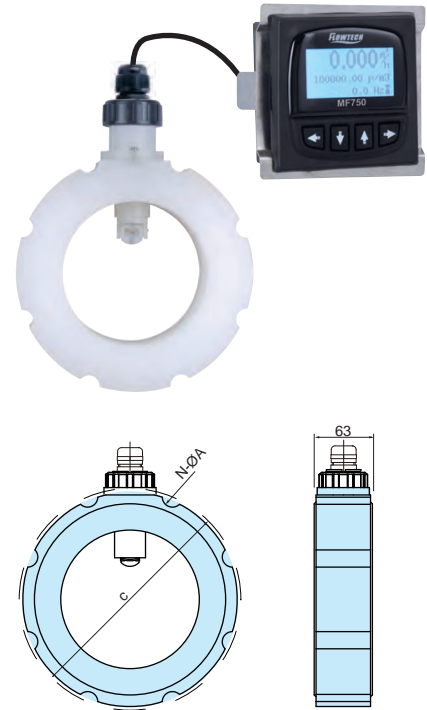

KF510

How to order

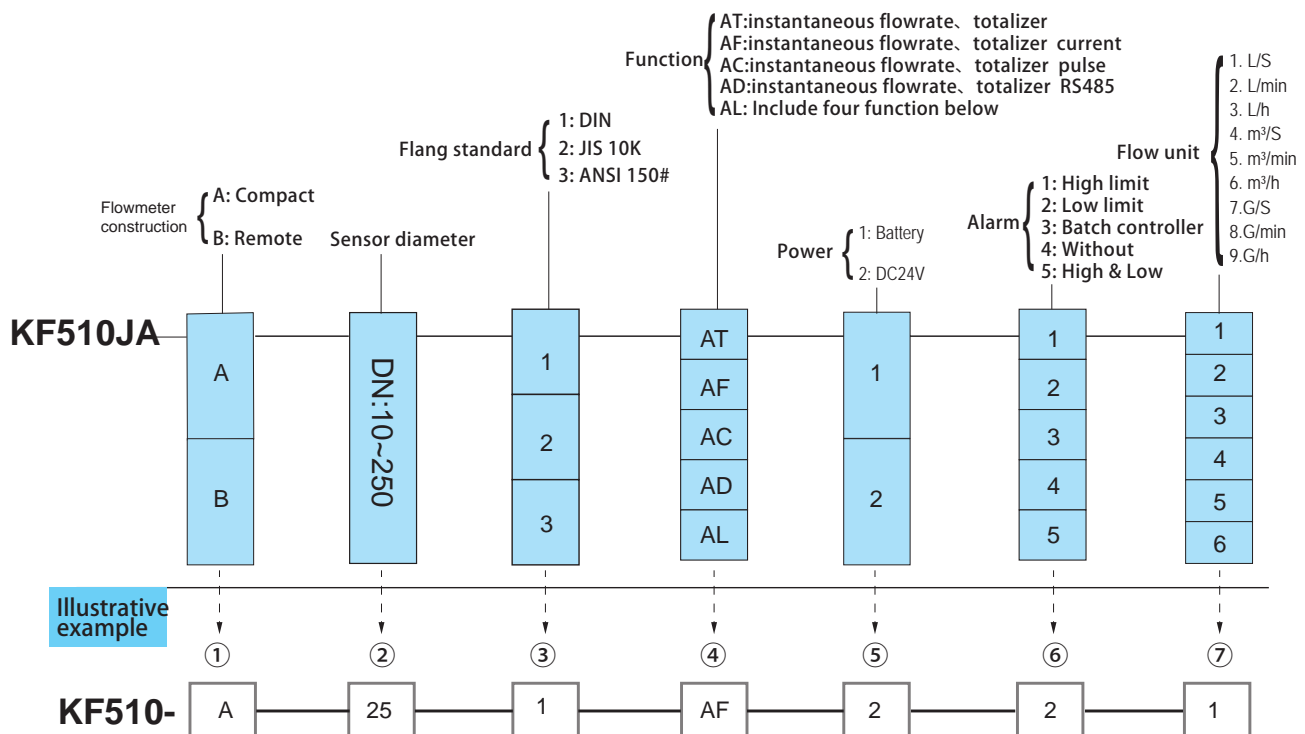

* Note : Battery type without output signal.
Selection of connection, please specify the standard.

5、 FA Flange type

B

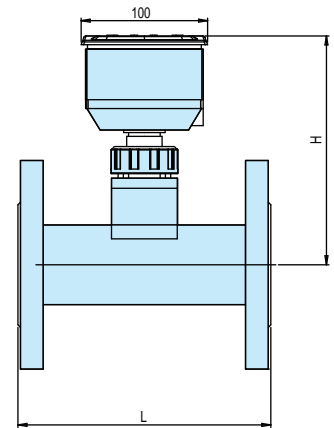
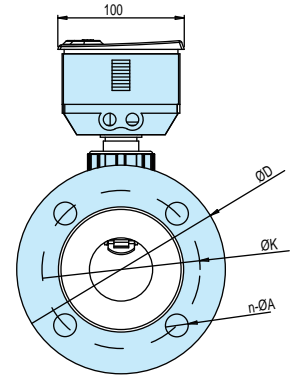

External dimensions

Unit: mm

DN	Pressure MPa	L	D	K	n-ØA	H
32	1¼"	200	140	100	4-Ø18	187
40	1½"	200	150	110	4-Ø18	192
50	2"	200	165	125	4-Ø18	198.5
65	2½"	200	185	145	8-Ø18	205
80	3"	200	200	160	8-Ø18	212
100	4"	250	220	180	8-Ø18	222
125	5"	250	250	210	8-Ø18	233
150	6"	300	285	240	8-Ø22	247
200	8"	350	340	295	8-Ø22	267
250	10"	400	395	350	12-Ø22	287

KF510

How to order

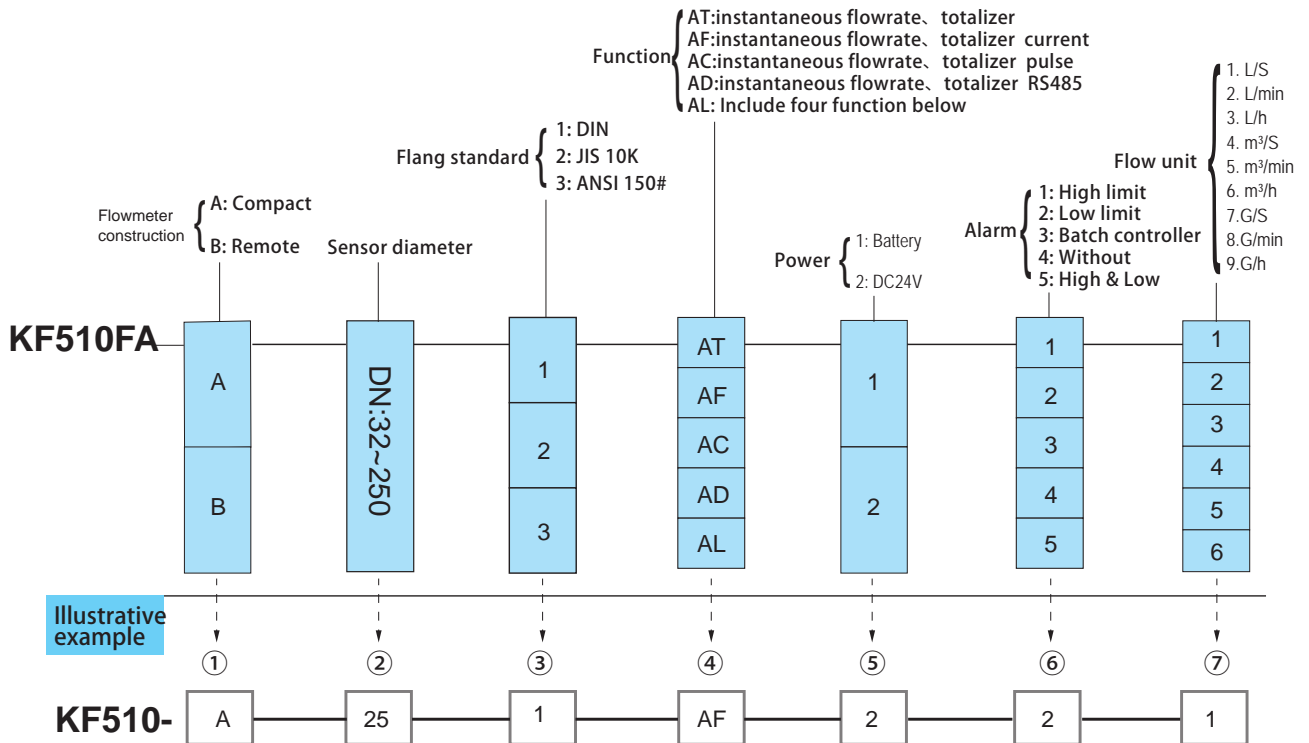

* Note : Battery type without output signal.
Selection of connection, please specify the standard.

KF510 Series

Paddlewheel Flowmeters

6、IT Insertion Type

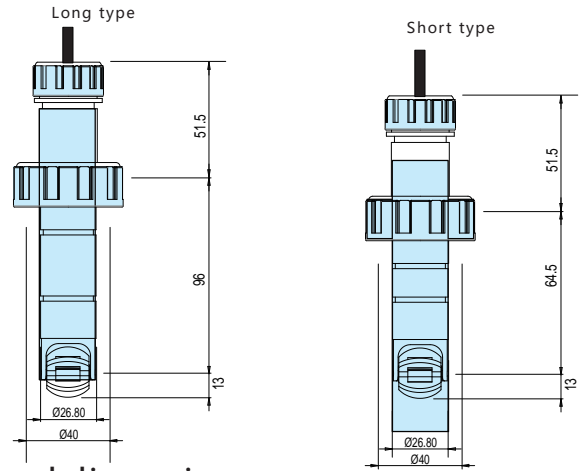

External dimensions mm

DN	d	L	D1	D2
50	63	68.5	40	50
65	75	68.5	40	50
80	90	68.5	40	50
110	125	100	40	50
125	140	100	40	50
150	160	100	40	50
200	225	100	40	50
250	280	100	40	50
300	315	100	40	50
350	370	100	40	50
400	420	100	40	50
450	470	100	40	50
500	520	100	40	50

PVC Pipeline installation

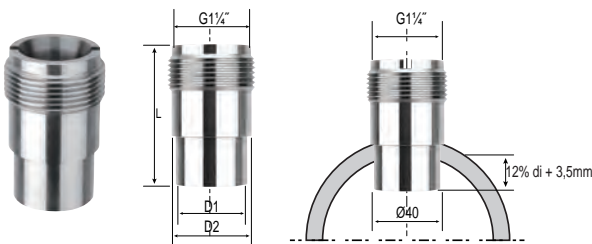

KF510

How to order

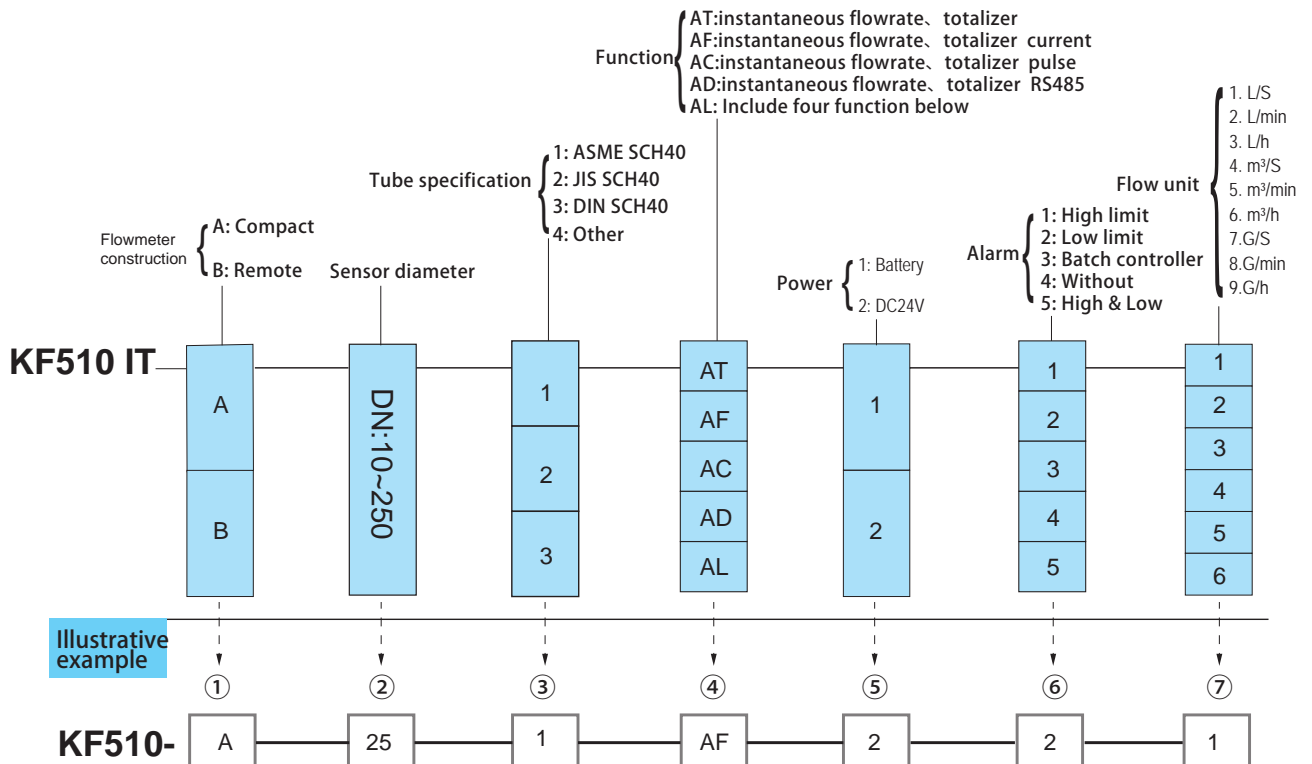

* Note : Battery type without output signal.
Please advise connection standard when purchase order.

B

7. SS saddle type

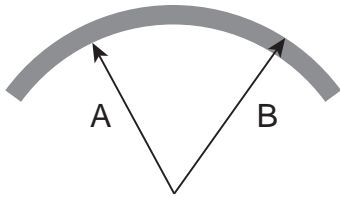

External dimensions

Unit : mm

D N	A	B	Pressure (MPa)
50	60.3	90	≤0.8
65	73	105	
80	89	120	
100	114	144	
125	140	170	
150	168	180	
200	219	250	
250	273	310	

KF510SS

How to order

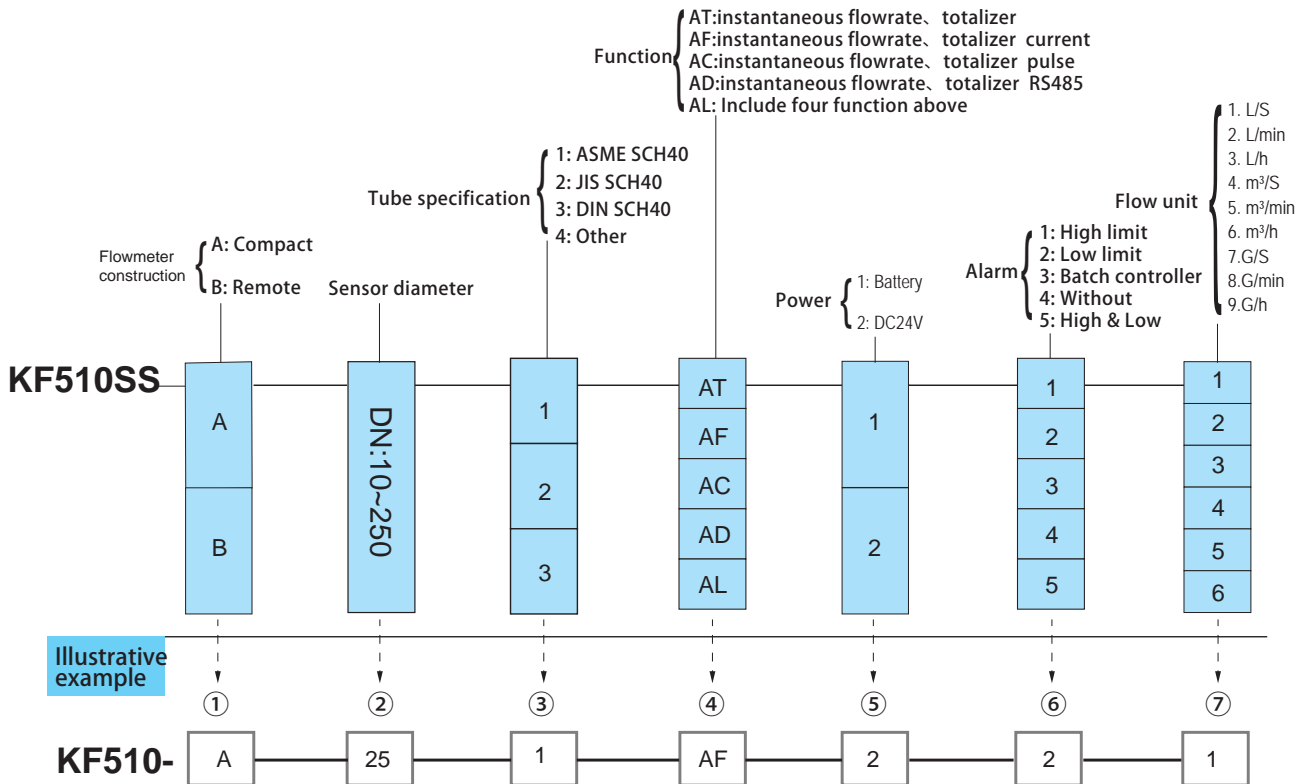

* Note : Battery type without output signal.
Selection of connection, please specify the standard.

KF510 Series

Paddlewheel Flowmeters

8、 KP glue type



External dimensions

External dimensions			Unit: mm
DN	Max Pressure MPa	L	Gule (id)
10	0.8	120	20
15		130	20
20		142	20
25		142	22
40		175	40
50		175	63

KF510SS

How to order

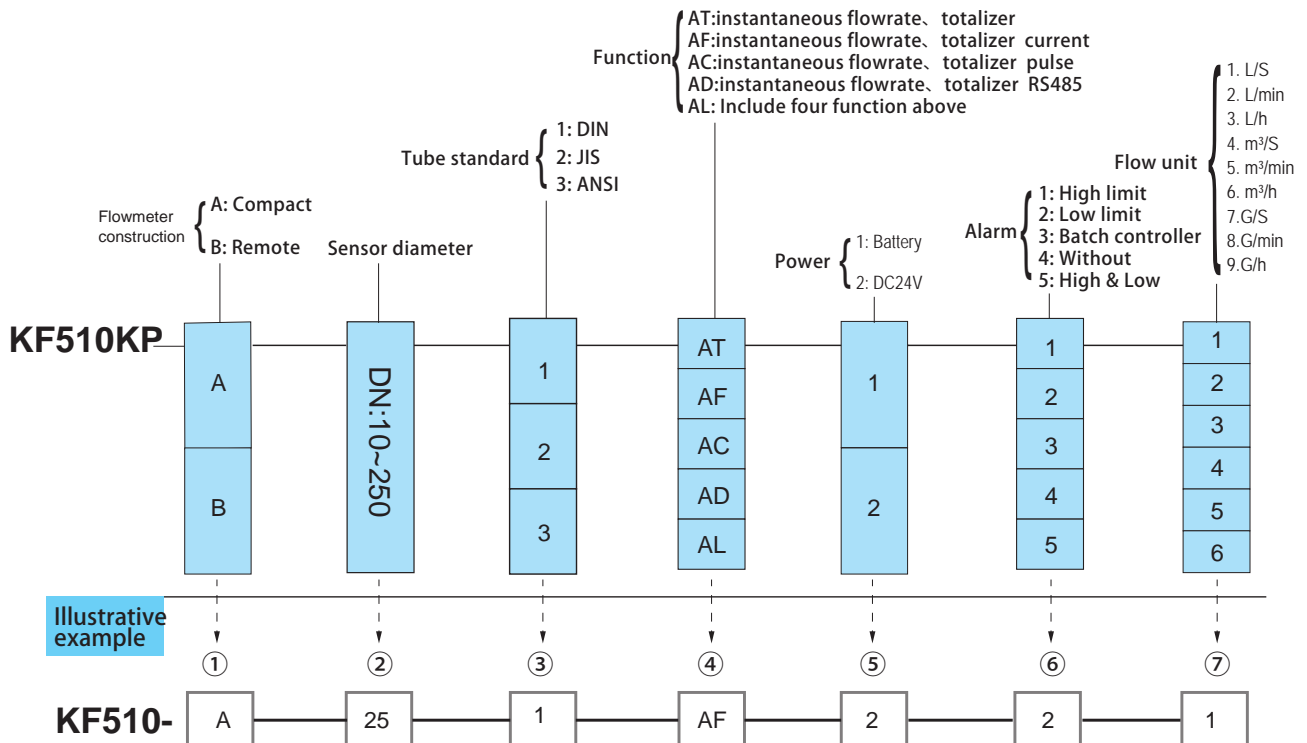

* Note : Battery type without output signal.
Selection of connection, please specify the standard.

B

Turbine transducers are used for the precise measurement of instantaneous flow rates and flow quantities of low-viscosity fluids. It can be widely used in the fields of Petrol, chemical industry, metallurgy, scientific research for measuring or control. Several output and display options can be selected.

- 1.PT: 3 wires, 24VDC power, pulse, output without local display
- 2.CT: 2wires, 24 VDC 4-20mA output without local display
- 3.BT: Battery power, instantaneous flowrate and totalizer
- 4.IT: 24VDC/85~265VAC, 4-20mA and pulse output with instantaneous flowrate and totalizer

Specifications



DN (mm)	Measuring range (m³/h)		Medium temp (°C)	PN (MPa)	Env. temp (°C)	Pressure loss (MPa)	
	Error 0.5%	Error 1.0%					
2*	/	0.01~0.13	-20~100	1.6	-25~55	0.12	
3*	/	0.04~0.25		6.3		0.08	
4*	/	0.04~0.25			16*		0.05
6*	0.1~0.6	0.1~0.6					
10	0.25~1.2	0.2~1.2			40*		0.025
15	0.6~4	0.4~4		2.5 or 6.3		0.025	
20	1.1~7	0.7~7			1.6 or 2.5		0.025
25	1.6~10	1~10		1.6		0.025	
32	2.5~16	1.6~16			1.6		0.025
40	3~20	2.5~25		1.6		0.025	
50	4~40	4~40			1.6		0.025
65	6~60	6~60		1.6		0.025	
80	10~100	10~100			1.6		0.025
100	20~160	16~160		1.6		0.025	
150	50~300	40~400			1.6		0.025
200	100~600	80~800		1.6		0.025	

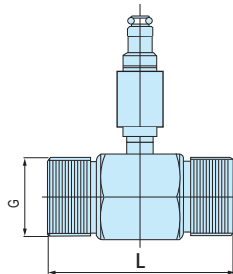

VA thread dimensions

DN	2*,3*,4*	6	10	15	20	25	32
BSP	1/4	3/8	1/2	1	1	1¼	1½
Lmm	40 55 40	50	50	75	75	100	120
KG	0.5 0.7 0.5	0.6	0.65	1.0	1.2	1.7	2.2

“*” special order

KF500 Series

Turbine Transducers

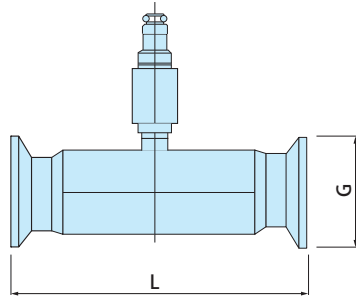

KA Tri-clamp dimensions

DN		G	L	Weights (KG)
10	3/8"	51	100	1
15	1/2"	51	100	1.1
20	3/4"	51	100	1.5
25	1"	51	100	2
32	1 1/4"	64	140	3.5
40	1 1/2"	64	140	5
50	2"	77.5	150	6.5
65	2 1/2"	91	182	8

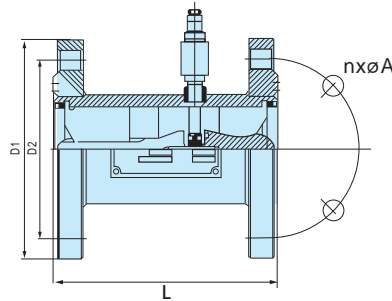

FA Flange dimensions

DN	D1	D2	nxøA	L	Weights (KG)
10	90	60	4x14	60	1.9
15	95	65	4x14	75	2.0
20	105	75	4x14	75	2.9
25	115	85	4x14	100	3.7
32	140	100	4x18	120	5
40	150	110	4x18	140	7
50	165	125	4x18	150	9
65	185	145	4x18	180	11
80	200	160	8x18	200	14
100	220	180	8x18	220	21
150	285	240	8x22	300	36
200	340	295	12x22	360	57

KF500

How to order

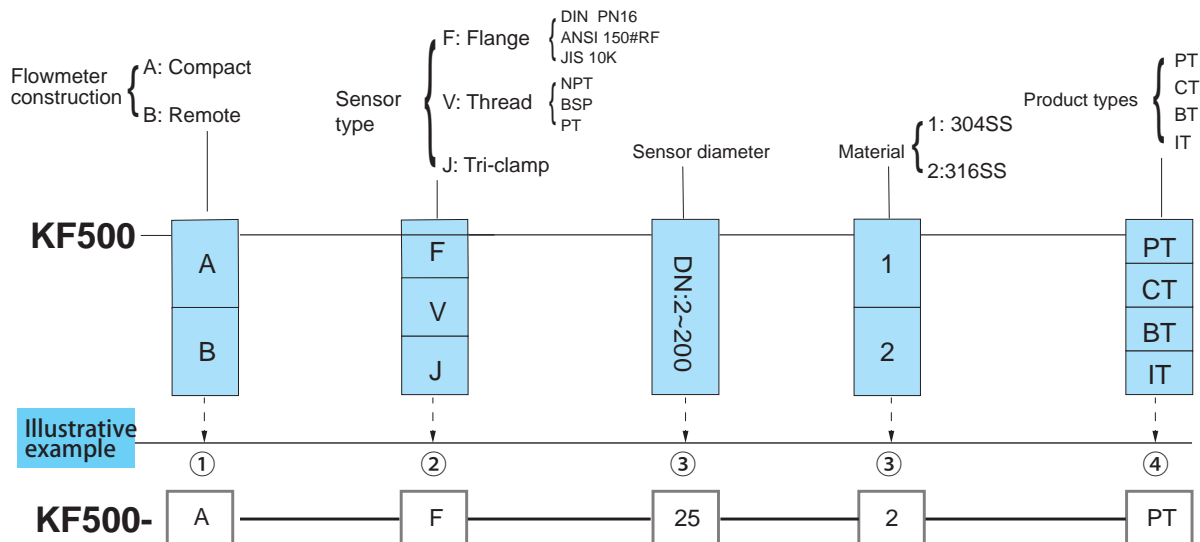

Turbine Transducers

B

Turbine transducers are used for the precise measurement of instantaneous flow rates and flow quantities of low-viscosity fluids. It can be widely used in the fields of Petrol, chemical industry, metallurgy, scientific research for measuring or control. Several output and display options can be selected.

- 1.PT: 3 wires, 24VDC power, pulse, output without local display
- 2.CT: 2wires, 24 VDC 4-20mA output without local display
- 3.BT: Battery power, instantaneous flowrate and totalizer
- 4.IT: 24VDC, 4-20mA and pulse output with instantaneous flowrate and totalizer



DN mm	LIQUIDS(m ³ /h)	Male BSP	Ambt(C)and Working press.
	±1%FS (DN6, DN10 1.5%FS)		
6	0.15-0.6m ³ /h	3/8"	Standard: Less than 50C Less than 10bar
10	0.2-1.2m ³ /h	1/2"	
15	0.4-4m ³ /h	1"	
20	0.6-6m ³ /h	1 1/4"	
25	0.9-9m ³ /h	1 1/4"	
32	1.4-14m ³ /h	1 3/4"	
40	2.2-22m ³ /h	DIN flange	Special: Less than 100C Less than 6bar
50	3.5-35m ³ /h	DIN flange	
65	6-60m ³ /h	DIN flange	
80	9-90m ³ /h	DIN flange	
100	14-140m ³ /h	DIN flange	

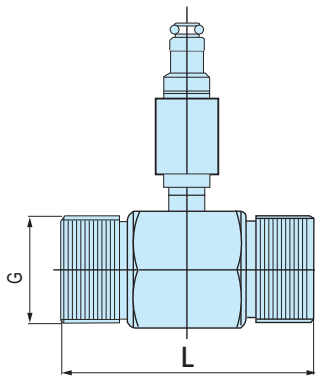

Thread screw type

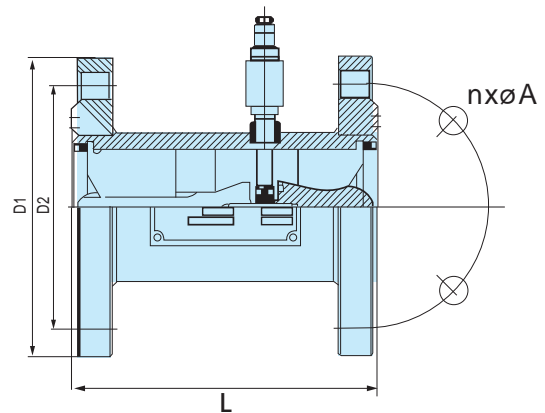

Flange type

KF500F Series

Turbine Transducers

Thread screw type(nominal diameter)

1.0MPa ,max working pressure is base on medium temprature

DN(mm)	15	20	25	32	40	50	65	80	100
G	G1	G1¼	G1¼	G1¾	G2	G2½	G3	G4	G5
L1mm	19	21	23	25	30	30	35	40	40
Lmm	80	85	100	120	140	150	185	200	220

Flange type

1.0MPa ,max working pressure is base on medium temprature

DN(mm)	15	20	25	32	40	50	65	80	100
D1	95	105	115	140	150	165	185	200	220
D2	65	75	85	100	110	125	145	160	180
d	14			18					
N	4							8	
L	75	85	100	120	140	150	185	200	220

KF500F

How to order

